



Proposed ADU: 896 sq ft
 ADU Porch: 72 sq ft
 Living space main house: _____ sq ft
 Adu above garage: _____ sq ft
 garage: _____ sq ft
 main house front porch: _____ sq ft

Lot size: _____ sq ft
 Lot coverage: _____ sq ft
 % of coverage: _____ %

Dead Loads: Roof 17 PSF, Floor 15 PSF
 Live Loads: Snow 25 PSF, Floor 40 PSF
 Lateral Loads: Seismic Zone D1
 Wind 120 MPH Exposure C

Energy compliance: 2017 Energy code
 Envelope enhancement measure 2
 Exterior Walls - Min. R 23 Insulation
 Floors - Min. R38 insulation
 Roof - Min. R49 insulation
 Windows - Min. U-0.28
 Conservation Measure D
 High efficiency water heater
 (gas/propane) minimum UEF0.85 /
 Electric Heat Pump Tier 1
 for Northern Climate

Attic Ventilation: 1 sq ft per 300 sq ft of Area
 Crawl space Ventilation: 1 sq ft per 150 sq ft of Area
 50% high & low

Included

- Cover Page
- Site Plan placeholder
- Main Floor Plan & Door/Window Schedule
- Exterior Elevations
- Foundation Plan & Concrete Details
- Building Details & Kitchen Plan
- Floor Framing Plan
- Roof framing Plans

Joist & Rafter Calc's.



5077 Table Rock Road
 Central Point OR 97502
 541-664-1214

Cover

Cascara

896 sq ft - 2 Bedroom

PROJECT NAME:	ADU 896	DRAWN BY:	JWL
SITE ADDRESS:	Medford, Oregon	SCALE :	N.T.S.
		DATE :	04-14-2021

Plan North
32' 0"

Plan West
28' 0"

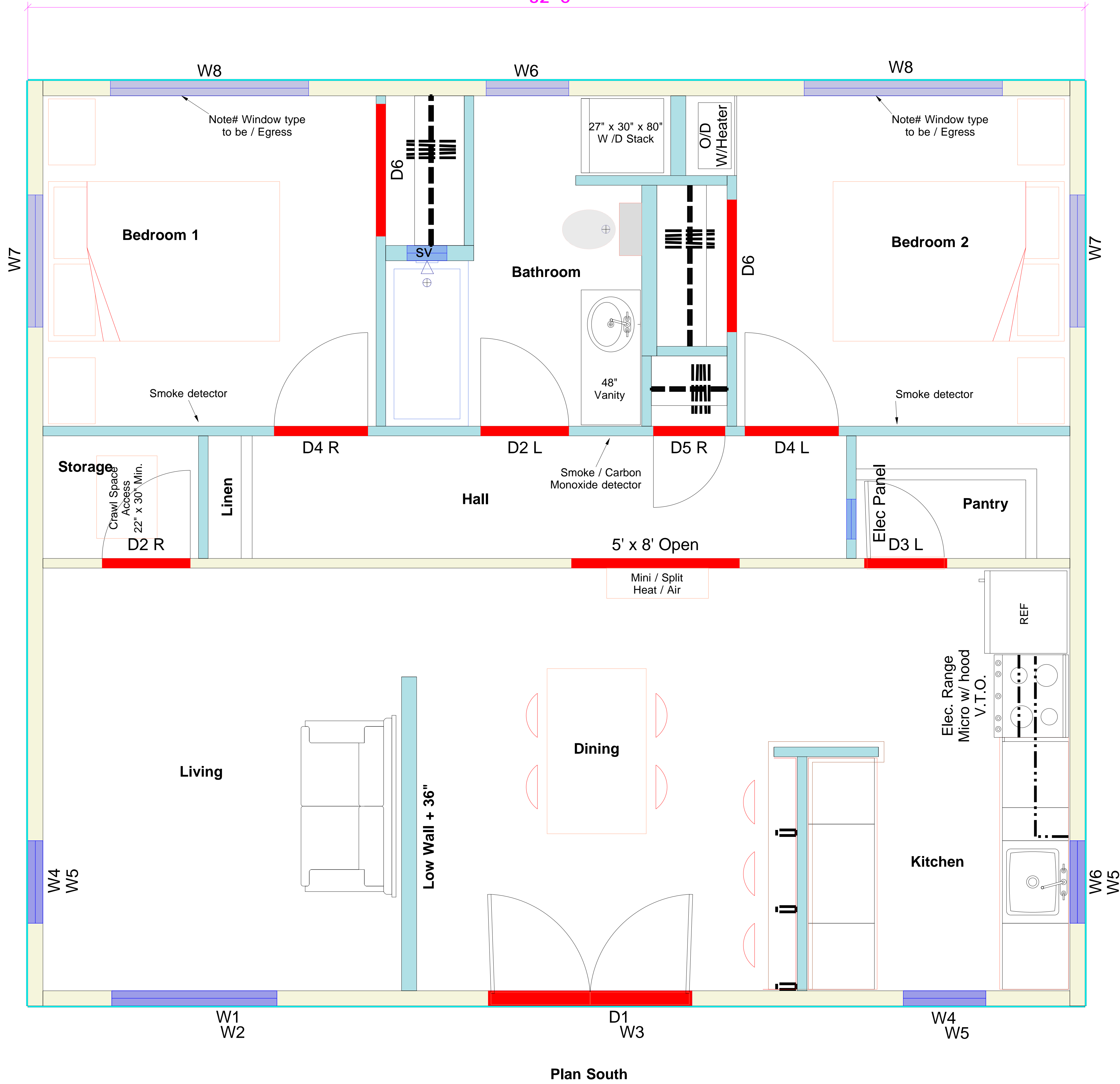

Plan East

Plan South



5077 Table Rock Road
Central Point OR 97502
541-664-1214

Main Floor Plan

PROJECT NAME:	Cascara
SITE ADDRESS:	Medford, Oregon

DRAWN BY:	JWL
SCALE:	N.T.S.
DATE:	04-14-2021