



Proposed ADU: 660 sq ft  
 ADU Porch: 72 sq ft  
 Living space main house: \_\_\_\_\_ sq ft  
 Adu above garage: \_\_\_\_\_ sq ft  
 garage: \_\_\_\_\_ sq ft  
 main house front porch: \_\_\_\_\_ sq ft

Lot size: \_\_\_\_\_ sq ft  
 Lot coverage: \_\_\_\_\_ sq ft  
 % of coverage: \_\_\_\_\_ %

Dead Loads: Roof 17 PSF, Floor 15 PSF  
 Live Loads: Snow 25 PSF, Floor 40 PSF  
 Lateral Loads: Seismic Zone D1  
 Wind 120 MPH Exposure C

Energy compliance: 2017 Energy code  
 Envelope enhancement measure 2  
 Exterior Walls - Min. R 23 Insulation  
 Floors - Min. R38 insulation  
 Roof - Min. R49 insulation  
 Windows - Min. U-0.28  
 Conservation Measure D  
 High efficiency water heater  
 (gas/propane) minimum UEF0.85 /  
 Electric Heat Pump Tier 1  
 for Northern Climate

Attic Ventilation: 1 sq ft per 300 sq ft of Area  
 Crawl space Ventilation: 1 sq ft per 150 sq ft of Area  
 50% high & low

Included

- Cover Page
- Site Plan placeholder
- Main Floor Plan
- Exterior Elevations
- Interior Elevations & Door/Window Schedule
- Foundation Plan
- Building & Concrete Details
- Floor Framing Plan
- Roof framing Plans

Joist & Rafter Calc's.



5077 Table Rock Road  
 Central Point OR 97502  
 541-664-1214

**Cover**

# Beech

## 660 sq ft - 1 Bedroom

PROJECT NAME:	ADU 660	DRAWN BY:	JWL
SITE ADDRESS:	Medford, Oregon	SCALE :	N.T.S.
		DATE :	04-09-2021

30' 0"

22' 0"

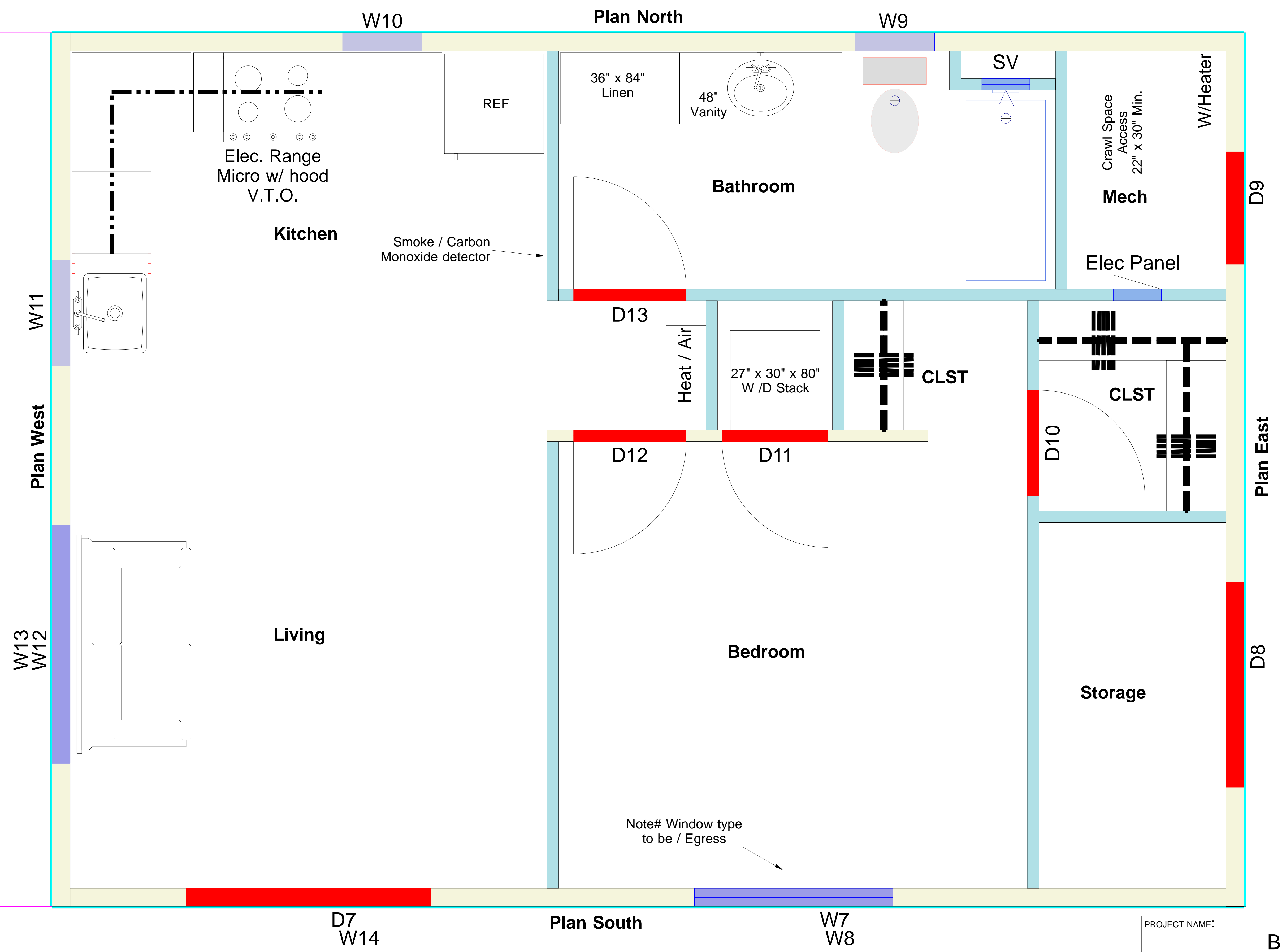

Note# Window type to be / Egress



5077 Table Rock Road  
 Central Point OR 97502  
 541-664-1214

**Main Floor Plan**

PROJECT NAME:	Beech
SITE ADDRESS:	Medford, Oregon

DRAWN BY:	JWL
SCALE :	N.T.S.
DATE :	04-09-2021